

X-RACK & X-SIEGE COMPONENTS FLYER

2025 X-RACK & X-SIEGE COMPONENTS

BAR SUPPORTS (2 PIECES - PAIR)



Product Code: BS

DESCRIPTION

- Polyurethane wear guards protect uprights and Olympic Bars
- 850 lb (385 kg) maximum training weight
- Aluminum knob spring pins prevent disengagement with the uprights

COMPATIBILITY

X-Create	√
X-Rack	√
X-Siege	√
TR-1	√
TR-2	√

BAR CATCHES (2 PIECES - PAIR)



Product Code: BC

DESCRIPTION

- Sold as a pair
- Polyurethane wear guards protect uprights and Olympic Bars
- 850 lb (385 kg) maximum training weight
- Aluminum knob spring pins prevent disengagement with the uprights

COMPATIBILITY

X-Create	√
X-Rack	√
X-Siege	√
TR-1	√
TR-2	√

2025 X-RACK & X-SIEGE COMPONENTS

ROCK CLIMBING KIT (2 PIECES - PAIR)



Product Code: XRACK-RCK

DESCRIPTION

- Sold as a left and right pair
- Mounts to any rectangular or monkey bar cross to provide rock grip locations
- Textured molded surface provides sure grip

COMPATIBILITY

X-Create	√
X-Rack	√
X-Siege	√
TR-1	√
TR-2	√

BALL TARGET

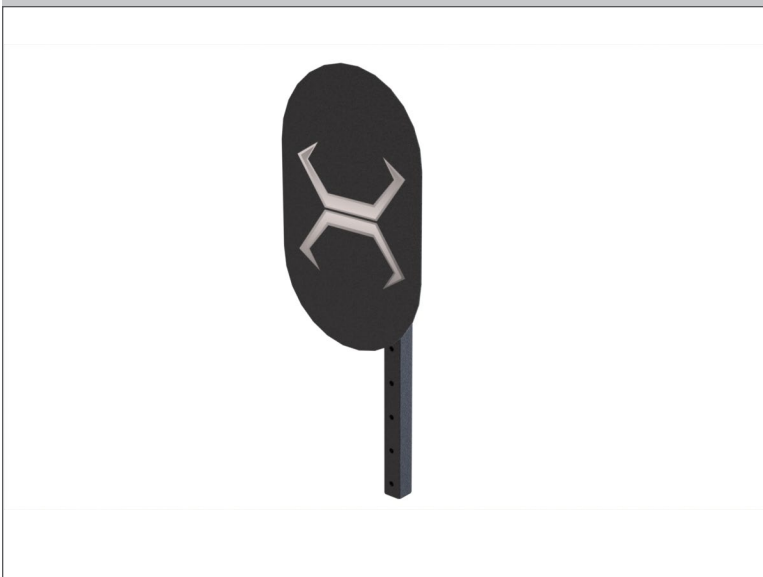

Product Code: BT

DESCRIPTION

- Oval design allows for 8' and 10' target heights
- Fully welded construction with no bolts on target that could damage wall balls

COMPATIBILITY

X-Create	
X-Rack	√
X-Siege	√
TR-1	√
TR-2	√

2025 X-RACK & X-SIEGE COMPONENTS

VERTICAL GROUND ROTATIONAL TRAINER



Product Code: GRT

DESCRIPTION

- Mounts to vertical uprights
- Provides three dimensional rotation movements
- Sized for use with an Olympic Bar
- Folds up against upright when not in use

COMPATIBILITY

X-Create	
X-Rack	√
X-Siege	
TR-1	
TR-2	

HORIZONTAL MOUNT GROUND ROTATIONAL TRAINER



Product Code: XHMGRT

DESCRIPTION

- Mounts horizontally to X-Create Uprights and Lower Band Peg Attachments on X-Rack and X-Siege Systems
- Molded rubber bumper provides stationary storage location for pivot

COMPATIBILITY

X-Create	√
X-Rack	√
X-Siege	√
TR-1	√
TR-2	√

2025 X-RACK & X-SIEGE COMPONENTS

TRIPLE PLAY

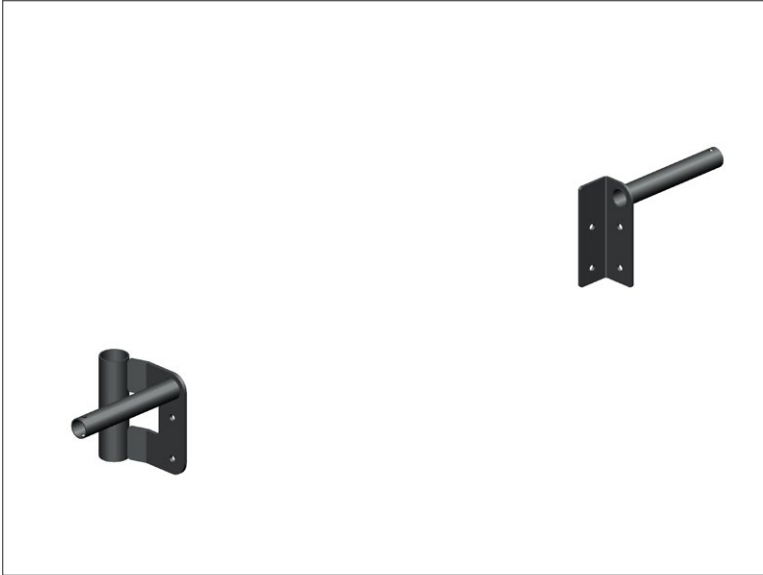

Product Code: TP

DESCRIPTION

- Functions as weight plate storage, Olympic Bar Storage and as a battle rope anchor
- Compatible with X-Rack Systems

COMPATIBILITY

X-Create	
X-Rack	√
X-Siege	
TR-1	
TR-2	

DOUBLE PLAY



Product Code: DP

DESCRIPTION

- Attaches to X-Rack uprights and X-Create Olympic Lifting uprights
- Holds Olympic Bar and provides an anchor for battle ropes

COMPATIBILITY

X-Create	√
X-Rack	√
X-Siege	
TR-1	
TR-2	

2025 X-RACK & X-SIEGE COMPONENTS

X-RACK BOOT



Product Code: XRBOOT

DESCRIPTION

- Compatible with all X-Rack and X-Siege systems.
- Boot provides a decorative cover of the base plates and floor mounting bolts and makes clean up easier around the X-Rack Systems.
- Note: must be installed before assembling X-Rack.

COMPATIBILITY

X-Create	
X-Rack	√
X-Siege	√
TR-1	
TR-2	

UNIVERSAL HEAVY BAG MOUNT



Product Code: UHBM-102

DESCRIPTION

- Can be mounted straight out or at an angle
- Newest version allows heavy bags to swivel and rotate smoothly on bronze oil impregnated bearings.
- Heavy Bag not included.

COMPATIBILITY

X-Create	
X-Rack	√
X-Siege	√
TR-1	√
TR-2	√

2025 X-RACK & X-SIEGE COMPONENTS

3-DIMENSIONAL SWIVEL WITH MOUNT



Product Code: XCREATE-3DSM

DESCRIPTION

- Connects to X-Create and X-Rack Monkey Bar and Rectangular Crosses.
- Allows heavy bags to swivel and rotate smoothly on bronze oil impregnated bearings.

COMPATIBILITY

X-Create	√
X-Rack	√
X-Siege	√
TR-1	
TR-2	

CABLE COLUMN



Product Code: XCC

DESCRIPTION

- Dual swivel pulleys for isolateral movements
- Mounts to walls, X-Racks and X-Siege Systems with 9' uprights
- 185 lb (84 kg) weight stack with 1:2 ratio
- XCC is the frame component. XCCS includes the weight stack

COMPATIBILITY

X-Create	
X-Rack	√
X-Siege	√
TR-1	
TR-2	

2025 X-RACK & X-SIEGE COMPONENTS

HANGING STORAGE HOOK

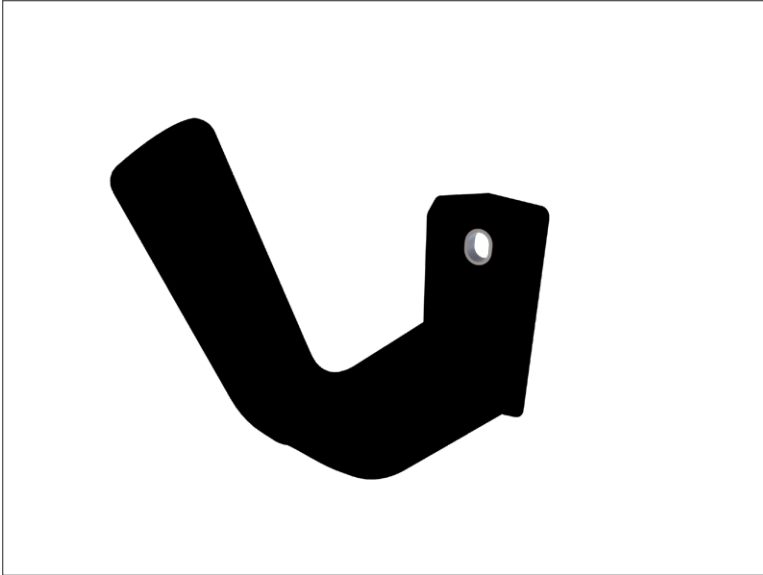

Product Code: XCREATE-HSH

DESCRIPTION

- Large 8.5 inch (21.6 cm) long nylon molded hook stores battle ropes or other hanging accessories.
- Compatible with all X-Create systems as well as X-Rack and X-Siege systems that have Accessory or Weight Storage uprights.
- Pairs well with the XRACK-BRA battle rope anchor.

COMPATIBILITY

X-Create	√
X-Rack	√
X-Siege	√
TR-1	
TR-2	

BATTLE ROPE ANCHOR



Product Code: XRACK-BRA

DESCRIPTION

- Glass-reinforced molded nylon anchor includes rounded edges to prevent wear on ropes.
- Molded in steel inserts in mounting holes.
- Mounts to uprights or the base of most X-Series Systems.

COMPATIBILITY

X-Create	√
X-Rack	√
X-Siege	√
TR-1	√
TR-2	√

2025 X-RACK & X-SIEGE COMPONENTS

DIP/STEP/ ATTACHMENT ANCHOR (2 PIECES - PAIR)



Product Code: XDSA

DESCRIPTION

- Interlocks with X-Create, X-Rack, X-Siege & X-Cage Lifting Uprights for adjustable height dip movements.
- Also can be used as a Step-Up to reach pull-up or monkey bars.
- Gussets have openings to be used with resistance band for adjustable height anchors.

COMPATIBILITY

X-Create	√
X-Rack	√
X-Siege	√
TR-1	√
TR-2	√

ENDLESS ROPE TRAINER



Product Code: XERT

DESCRIPTION

- Relentless Rope features a variable resistance magnet brake with four levels of starting resistance.
- Included brackets allow for mounting to almost all Torque systems.

COMPATIBILITY

X-Create	√
X-Rack	√
X-Siege	√
TR-1	√
TR-2	√

2025 X-RACK & X-SIEGE COMPONENTS

PULL-UP SIDE



Product Code: XPUS

DESCRIPTION

- Combine with XWMPUX to lengthen any Wall Mounted Pull-Up System.
- Compatible with X-Racks paired with monkey bars for crosses. Combine with Monkey Bar Crosses.
- Raises X-Rack to height of 115.6 in (294 cm) to 119.1 in (302 cm) depending on set-up.

COMPATIBILITY

X-Create	
X-Rack	√
X-Siege	√
TR-1	
TR-2	

3 FT (0.9 M) UPRIGHT EXTENTION (QTY 2)



Product Code: XRACK-3UE

DESCRIPTION

- Designed for use with the XRACK-12U 12' uprights to bring the rack height up to 15' to allow for climbing ropes.
- Four L-Brackets are used to secure extensions to the uprights for complete stability.

COMPATIBILITY

X-Create	
X-Rack	√
X-Siege	
TR-1	
TR-2	

2025 X-RACK & X-SIEGE COMPONENTS

SKIER, RELENTLESS RIPPER



Product Code: XRR-SKI

DESCRIPTION

- Features 10 levels of progressive magnetic resistance
- Included brackets allow for mounting to almost all Torque systems
- Console tracks time, strokes per minute, watts, calories, distance, and more.

COMPATIBILITY

X-Create	√
X-Rack	√
X-Siege	√
TR-1	√
TR-2	√

4 FT (1.2 M) DOUBLE CROSS



Product Code: XRACK-4DX

DESCRIPTION

- Includes 1.25" and 2" pull-up bars.
- Can be mounted in either direction for "fat bar" or "skinny bar" down.

COMPATIBILITY

X-Create	
X-Rack	√
X-Siege	√
TR-1	
TR-2	

2025 X-RACK & X-SIEGE COMPONENTS

4 FT (1.2 M) FLYING PULL-UP



Product Code: XRACK-4FPU

DESCRIPTION

- The flying pull-up cross attaches to any X-Rack 4' training space.
- Provides an extended 10' high anchor for rings without compromising a pull-up station or requiring additional floor space.
- Raises X-Rack to height of 117.1 in (297 cm) to 127.5 in (324 cm) depending on set-up.

COMPATIBILITY

X-Create	
X-Rack	√
X-Siege	√
TR-1	
TR-2	

4 FT (1.2 M) MONKEY BAR

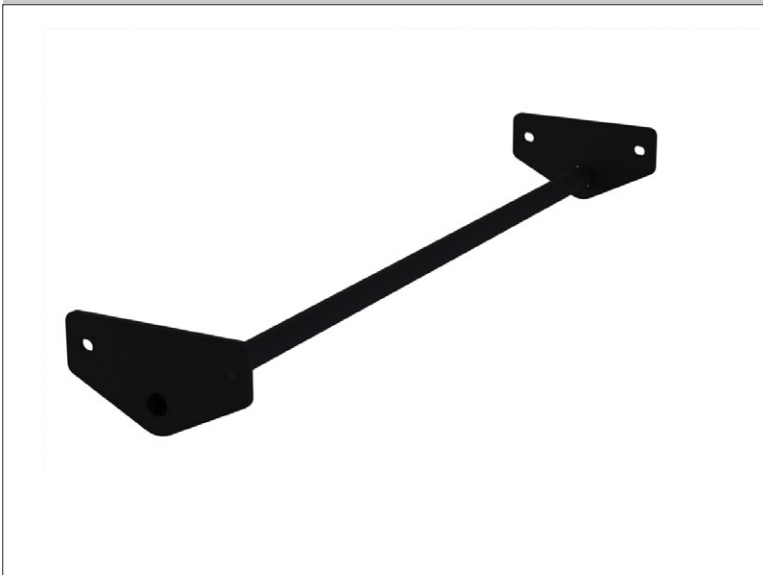

Product Code: XRACK-4MB

DESCRIPTION

- Connects to the X-Rack and X-Siege Monkey Bar Cross members.
- Can be mounted with all the same height, or flipped for stair step monkey bars.
- Thru-plate fully welded construction.

COMPATIBILITY

X-Create	√
X-Rack	√
X-Siege	√
TR-1	
TR-2	

2025 X-RACK & X-SIEGE COMPONENTS

4 FT (1.2 M) MONKEY LADDER CROSS



Product Code: XRACK-4MBLX

DESCRIPTION

- Allows Monkey Bars to rise from 9 feet to 12 feet.
- Pair with two 4' or 6' Monkey Bars.

COMPATIBILITY

X-Create	
X-Rack	√
X-Siege	√
TR-1	
TR-2	

4 FT (1.2 M) MONKEY BAR CROSS



Product Code: XRACK-4MBX

DESCRIPTION

- Includes 3" x 3" 11 gauge upper tube for attaching Monkey Bars and a 1.25" diameter tube for pull-ups.

COMPATIBILITY

X-Create	
X-Rack	√
X-Siege	√
TR-1	
TR-2	

2025 X-RACK & X-SIEGE COMPONENTS

4 FT (1.2 M) MULTI-GRIP CROSS



Product Code: XRACK-4MGX

DESCRIPTION

- Includes solid 1.25" diameter ergonomic handles and a 2" diameter "fat grip" straight bar for four different pull-up variations
- Compatible with all X-RACK, X-SIEGE and Torque Rack systems

COMPATIBILITY

X-Create	
X-Rack	√
X-Siege	√
TR-1	√
TR-2	√

4 FT (1.2 M) NINJA CROSS



Product Code: XRACK-4NX

DESCRIPTION

- 4' cross attaches to any 4 foot X-Rack or X-Seige Space, including Monkey Bar Racks as well as TR Racks
- Incorporates multiple grip variations, including angled straight bar, fat bar, 3" sphere, 4" sphere and rock grip.

COMPATIBILITY

X-Create	
X-Rack	√
X-Siege	√
TR-1	√
TR-2	√

2025 X-RACK & X-SIEGE COMPONENTS

4 FT (1.2 M) RECTANGULAR CROSS



Product Code: XRACK-4RX

DESCRIPTION

- Constructed with 3 x 3 inch 11 gauge with gussets, the rectangular cross provides a more rigid X-RACK frame connection.
- Required for 4 foot depth racks with weight or accessory storage uprights.
- Can be substituted for 4MBX Monkey Bar Cross.

COMPATIBILITY

X-Create	
X-Rack	√
X-Siege	√
TR-1	√
TR-2	√

4 FT (1.2 M) SINGLE CROSS



Product Code: XRACK-4SX

DESCRIPTION

- 1.25 inch diameter pull-up bar featuring “thru-plate” construction with gussets.
- Preferred cross member for performing muscle-ups.
- Compatible with all X-RACKS, X-SIEGE, and TR Racks

COMPATIBILITY

X-Create	
X-Rack	√
X-Siege	√
TR-1	√
TR-2	√

2025 X-RACK & X-SIEGE COMPONENTS

4 FT (1.2 M) TRIPLE CROSS



Product Code: XRACK-4TX

DESCRIPTION

- Constructed with three 1.25" diameter pull-up bars with "thru-plate" construction.
- Allows for two different pull-up heights at the same station.

COMPATIBILITY

X-Create	
X-Rack	√
X-Siege	√
TR-1	√
TR-2	√

6 FT (1.8 M) ACCESSORY TRAY



Product Code: XRACK-6AT

DESCRIPTION

- For use with X-RACK or X-SIEGE systems
- Trays can be mounted flat for use with medicine balls, kettlebells etc. or at an angle for use with hex dumbbells.

COMPATIBILITY

X-Create	
X-Rack	√
X-Siege	√
TR-1	
TR-2	

2025 X-RACK & X-SIEGE COMPONENTS

6 FT (1.8 M) DOUBLE CROSS MEMBER



Product Code: XRACK-6DX

DESCRIPTION

- Includes 1.25" and 2" pull-up bars.
- Can be mounted in either direction for "fat bar" or "skinny bar" down.
- Can be mounted horizontally for stability ball storage. (Requires XUHK1)

COMPATIBILITY

X-Create	
X-Rack	√
X-Siege	√
TR-1	
TR-2	√

6 FT (1.8 M) HORIZONTAL WEIGHT STORAGE



Product Code: XRACK-6HWS

DESCRIPTION

- Six 7.5 inch (190 mm) solid steel weight pegs with nylon covers and rubber bumpers to protect weight plates.
- Compatible with X-Rack, X-Siege and 6' Horizontal Storage Racks.
- Pegs are spaced apart to all hold 45 lb. plates.

COMPATIBILITY

X-Create	√
X-Rack	√
X-Siege	√
TR-1	
TR-2	

2025 X-RACK & X-SIEGE COMPONENTS

6 FT (1.8 M) MONKEY BAR



Product Code: XRACK-6MB

DESCRIPTION

- Connects to the XRACK-4MBX and XRACK-6MBX Monkey Bar Cross members.
- Can be mounted with all bars at the same height or flipped for stair step monkey bars.
- Use with X-Create to space lifting stations 6' apart.

COMPATIBILITY

X-Create	√
X-Rack	√
X-Siege	√
TR-1	
TR-2	

6 FT (1.8 M) MONKEY LADDER CROSS



Product Code: XRACK-6MBLX

DESCRIPTION

- Allows Monkey Bars to rise and descend between 9' and 12' uprights.
- Pair with three 4' or 6' Monkey Bars.

COMPATIBILITY

X-Create	
X-Rack	√
X-Siege	√
TR-1	
TR-2	

2025 X-RACK & X-SIEGE COMPONENTS

6 FT (1.8 M) MONKEY BAR CROSS



Product Code: XRACK-6MBX

DESCRIPTION

- Includes 3" x 3" 11 gauge upper tube for attaching Monkey Bars and a 1.25" diameter tube for pull-ups.

COMPATIBILITY

X-Create	
X-Rack	√
X-Siege	√
TR-1	
TR-2	√

6 FT (1.8 M) RECTANGULAR CROSS



Product Code: XRACK-6RX

DESCRIPTION

- Constructed with 3 x 3 inch 11 gauge with gussets, the rectangular cross provides a more rigid X-Rack frame connection.

COMPATIBILITY

X-Create	
X-Rack	√
X-Siege	√
TR-1	
TR-2	√

2025 X-RACK & X-SIEGE COMPONENTS

6 FT (1.8 M) SINGLE CROSS



Product Code: XRACK-6SX

DESCRIPTION

- 1.25 inch diameter pull-up bar featuring “thru-plate” construction with gussets.
- Preferred cross member for performing muscle-ups.

COMPATIBILITY

X-Create	
X-Rack	√
X-Siege	√
TR-1	
TR-2	√

6 FT (1.8 M) TRIPLE CROSS



Product Code: XRACK-6TX

DESCRIPTION

- Constructed with three 1.25” diameter pull-up bars with “thru-plate” constructions.
- Allows for two different pull-up heights at the same station.

COMPATIBILITY

X-Create	
X-Rack	√
X-Siege	√
TR-1	
TR-2	√

2025 X-RACK & X-SIEGE COMPONENTS

6 FT (1.8 M) UPRIGHT EXTENSION (QTY 2)



Product Code: XRACK-6UE

DESCRIPTION

- Designed for use with the XRACK-12U 12' uprights to bring the rack height up to 18' to allow for climbing ropes.
- Four L-Brackets are used to secure extensions to the uprights for complete stability.

COMPATIBILITY

X-Create	
X-Rack	√
X-Siege	
TR-1	
TR-2	

8 FT (2.4 M) UPRIGHT



Product Code: XRG2-U8

DESCRIPTION

- 3 x 3 11 gauge upright 8' length
- Optional on X-Rack or X-Siege
- Laser cut numbered slots
- Standard color options

COMPATIBILITY

X-Create	
X-Rack	√
X-Siege	√
TR-1	
TR-2	

2025 X-RACK & X-SIEGE COMPONENTS

9 FT (2.7 M) UPRIGHT



Product Code: XRG2-U9

DESCRIPTION

- 3 x 3 11 gauge upright 9' length.
- Standard on X-Rack and X-Siege
- Laser cut numbered slots
- Standard color options

COMPATIBILITY

X-Create	
X-Rack	√
X-Siege	√
TR-1	
TR-2	

8 FT (2.4 M) UPRIGHT VERTICAL ACCESSORY STORAGE



Product Code: XRACK-8UVAS

DESCRIPTION

- Attaches inside X-Racks with 8 foot uprights, providing an upright to attach 6' accessory trays and horizontal weight storage. Not compatible with X-Siege.
- Sold individually.
- Must be used with XRACK-4RX or XRACK-6RX Cross Members.

COMPATIBILITY

X-Create	
X-Rack	√
X-Siege	
TR-1	
TR-2	

2025 X-RACK & X-SIEGE COMPONENTS

8 FT (2.4 M) UPRIGHT VERTICAL WEIGHT STORAGE (QTY 2)



Product Code: XRACK-8UVWS

DESCRIPTION

- Attaches inside X-Racks with 8 foot uprights, providing weight storage. Sold as set of 2.
- Also can be used to attach 6' accessory trays and horizontal weight storage. Not compatible with X-Siege.
- Must be used with XRACK-4RX or XRACK-6RX Cross Members.

COMPATIBILITY

X-Create	
X-Rack	√
X-Siege	
TR-1	
TR-2	

9 FT (2.7 M) UPRIGHT VERTICAL ACCESSORY STORAGE

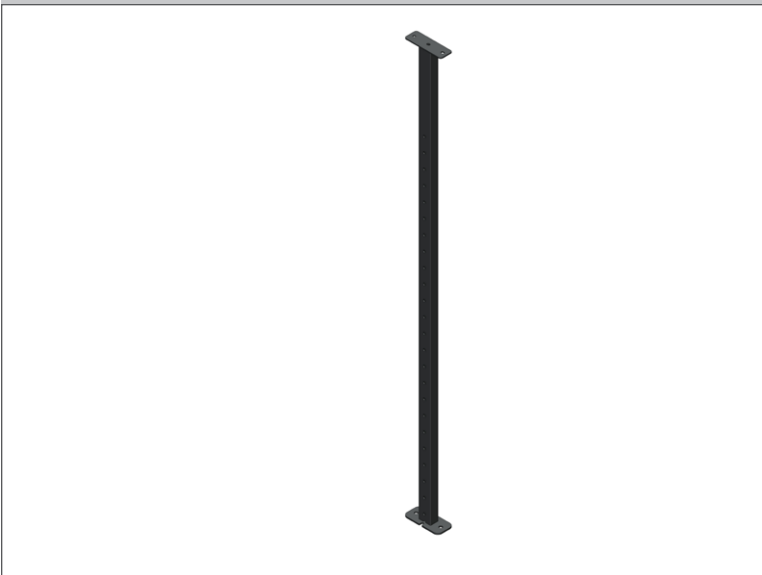

Product Code: XRACK-9UVAS

DESCRIPTION

- Attaches inside X-Racks with 9 foot uprights, providing an upright to attach 6' accessory trays and horizontal weight storage. Not compatible with X-Siege.
- Sold individually.
- Must be used with XRACK-4RX or XRACK-6RX Cross Members.

COMPATIBILITY

X-Create	
X-Rack	√
X-Siege	
TR-1	
TR-2	

2025 X-RACK & X-SIEGE COMPONENTS

9 FT (2.7 M) UPRIGHT VERTICAL WEIGHT STORAGE (QTY 2)



Product Code: XRACK-9UVWS

DESCRIPTION

- Eight solid steel weight pegs with nylon covers and rubber bumpers to protect weight plates.
- Must be used with XRACK-4RX or XRACK-6RX Cross Members.
- Not compatible with X-Siege.
- Sold as set of 2.

COMPATIBILITY

X-Create	
X-Rack	√
X-Siege	
TR-1	
TR-2	

4 FT (1.2 M) MULTI-GRIP RECTANGLE CROSS



Product Code: XRACK-4MGRX

DESCRIPTION

- Includes 1¼" solid steel multi-grips for pull-up and chin-up variety
- Welded gussets add increased stability for overall rig or rack system

COMPATIBILITY

X-Create	√
X-Rack	√
X-Siege	
TR-1	√
TR-2	√

2025 X-RACK & X-SIEGE COMPONENTS

UPPER BAND PEG ATTACHMENT (2 PIECES - PAIR)



Product Code: XRACK-UBPA

DESCRIPTION

- Mounts to any of our rack uprights except XHC which has them built in. (Cannot be used on uprights that include ball targets)
- Enables Olympic bar training with resistance bands.

COMPATIBILITY

X-Create	
X-Rack	√
X-Siege	√
TR-1	
TR-2	

LOWER BAND PEG ATTACHMENT (2 PIECES - PAIR)



Product Code: XRACK-LBPA

DESCRIPTION

- Compatible with X-Rack and X-Siege systems.
- Increases rack stability and enables resistance bands to be used with Olympic bar training.

COMPATIBILITY

X-Create	
X-Rack	√
X-Siege	√
TR-1	
TR-2	

2025 X-RACK & X-SIEGE COMPONENTS

3 FT (0.9 M) RECTANGULAR CROSS



Product Code: XRACK-3RX

DESCRIPTION

- Constructed with 3 x 3 inch 11 gauge with gussets, the rectangular cross provides a more rigid X-Rack frame connection.
- Compatible with accessory and weight storage uprights on X-Rack and X-Siege Systems.

COMPATIBILITY

X-Create	
X-Rack	√
X-Siege	√
TR-1	
TR-2	

STORAGE RACK ATTACHMENT ANCHOR SIDES (2 PIECES - PAIR)



Product Code: XSRAAS

DESCRIPTION

- Used with 6' Horizontal Storage Racks, and can be combined with accessory storage uprights and 6' accessory trays to create storage outriggers on X-Racks..
- 58.5" (149 cm) in height; Supports 4 trays.

COMPATIBILITY

X-Create	
X-Rack	√
X-Siege	
TR-1	
TR-2	

2025 X-RACK & X-SIEGE COMPONENTS

UPRIGHT GUSSET PLATE (2 PIECES - PAIR)

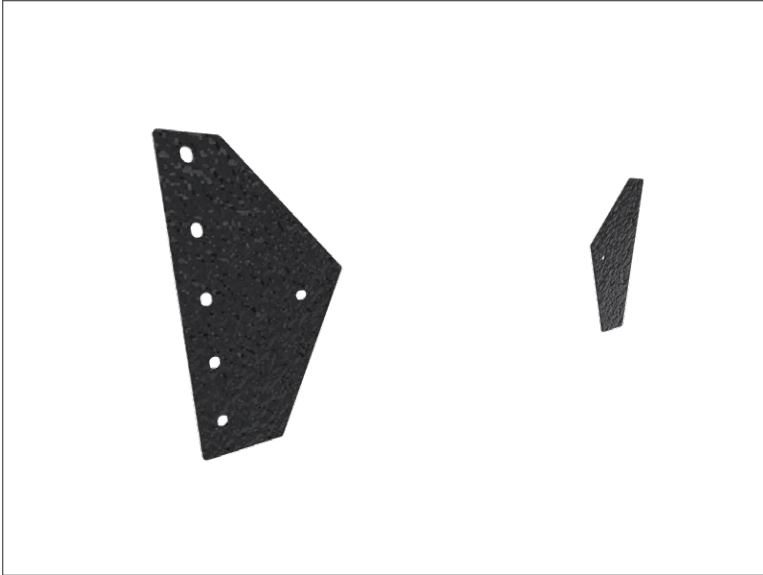

Product Code: XRACK-UGP

DESCRIPTION

- Standard on X-Siege systems and compatible with some X-Rack systems.
- Ties together uprights and crosses in two directions increasing stability of the system.
- Sold as pair for use at the ends of racks.

COMPATIBILITY

X-Create	
X-Rack	√
X-Siege	√
TR-1	
TR-2	

VERTICAL BAR CATCH & ACCESSORY STORAGE



Product Code: XRACK-VBCAS

DESCRIPTION

- Provides hanging storage for resistance bands, handles, chains, etc.
- Allows for storage of bar catches, supports or the dip attachment.
- Mounts between two vertical weight

COMPATIBILITY

X-Create	
X-Rack	√
X-Siege	√
TR-1	
TR-2	

2025 X-RACK & X-SIEGE COMPONENTS

4 FT (1.2 M) LOWER FRAME SUPPORT



Product Code: XSIEGE-4LFS

DESCRIPTION

- Standard on 4' depth Siege systems.
- Ties together uprights providing added stability.
- Includes two Olympic bar storage locations.

COMPATIBILITY

X-Create	
X-Rack	
X-Siege	√
TR-1	
TR-2	

6 FT (1.8 M) LOWER FRAME SUPPORT



Product Code: XSIEGE-6LFS

DESCRIPTION

- Standard on 6' depth Siege systems.
- Ties together uprights providing added stability.
- Includes two Olympic bar storage locations.

COMPATIBILITY

X-Create	
X-Rack	
X-Siege	√
TR-1	
TR-2	

2025 X-RACK & X-SIEGE COMPONENTS

8 FT (2.4 M) UPRIGHT VERTICAL WEIGHT STORAGE (QTY 2)



Product Code: XSIEGE-8UVWS

DESCRIPTION

- Mounts between lower frame supports and rectangular crosses on 8' X-Siege systems. (Not compatible with X-Racks.)
- Extra long nylon covered weight horns provide storage for three bumper plates on each peg.

COMPATIBILITY

X-Create	
X-Rack	
X-Siege	√
TR-1	
TR-2	

9 FT (2.7 M) UPRIGHT VERTICAL WEIGHT STORAGE (QTY 2)



Product Code: XSIEGE-9UVWS

DESCRIPTION

- Mounts between lower frame supports and rectangular crosses on 9' X-Siege systems. (Not compatible with X-Racks.)
- Extra long nylon covered weight horns provide storage for three bumper plates on each peg.

COMPATIBILITY

X-Create	
X-Rack	
X-Siege	√
TR-1	
TR-2	

2025 X-RACK & X-SIEGE COMPONENTS

8 FT (2.4 M) UPRIGHT VERTICAL ACCESSORY STORAGE

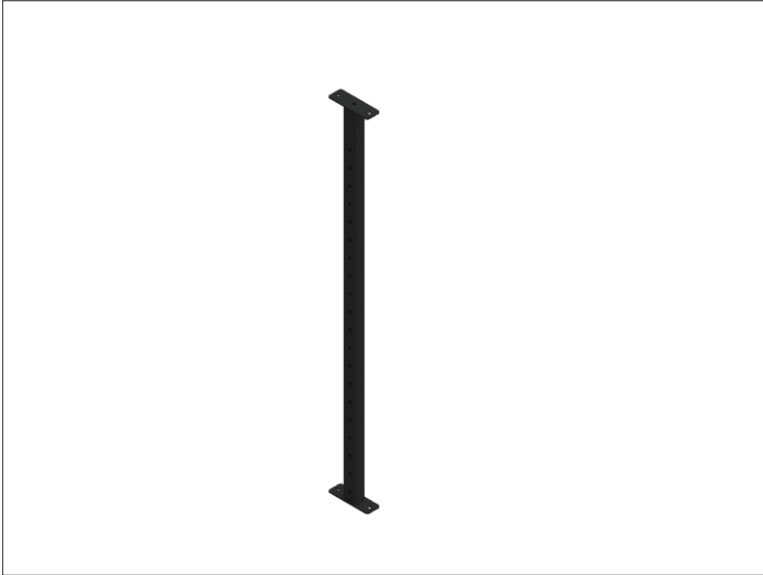

Product Code: XSIEGE-8UVAS

DESCRIPTION

- Mounts between lower frame supports and rectangular crosses on 8' X-Siege systems. (Not compatible with X-Racks.)
- 20 holes allows for height adjustment for multiple 6 foot accessory trays.
- Sold individually.

COMPATIBILITY

X-Create	
X-Rack	
X-Siege	√
TR-1	
TR-2	

9 FT (2.7 M) UPRIGHT VERTICAL ACCESSORY STORAGE

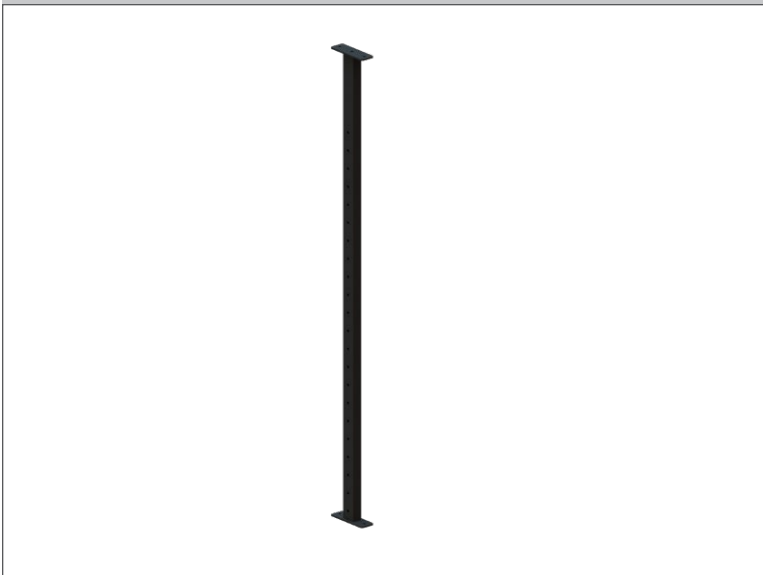

Product Code: XSIEGE-9UVAS

DESCRIPTION

- Mounts between lower frame supports and rectangular crosses on 9' X-Siege systems. (Not compatible with X-Racks.)
- 22 holes allows for height adjustment for multiple 6 foot accessory trays.
- Sold individually.

COMPATIBILITY

X-Create	
X-Rack	
X-Siege	√
TR-1	
TR-2	

2025 X-RACK & X-SIEGE COMPONENTS

WEIGHT STORAGE NUMBERING KIT, 5-55 LB



Product Code: WSNK5-55

DESCRIPTION

- Molded caps snap over weight peg bolts to provide location indicators for bumper plates.
- Includes six each of 10, 25, 35, and 45 lb indicators
- Compatible with all X-Series products with weight pegs.

COMPATIBILITY

X-Create	√
X-Rack	√
X-Siege	√
TR-1	√
TR-2	√

HARDWARE COVER FINISH KIT - 18 HOLES



Product Code: XHCFK-18BH

DESCRIPTION

- The Nut Caps serve as a washer replacement and hide exposed bolt threads, protecting accessories from damage.
- The Socket Head Cap Screw Covers replace washers and upgrade the aesthetics of your system, giving the X-Create a more refined look.

COMPATIBILITY

X-Create	√
X-Rack	√
X-Siege	√
TR-1	√
TR-2	√

2025 X-RACK & X-SIEGE COMPONENTS

UNIVERSAL HARDWARE KIT 1

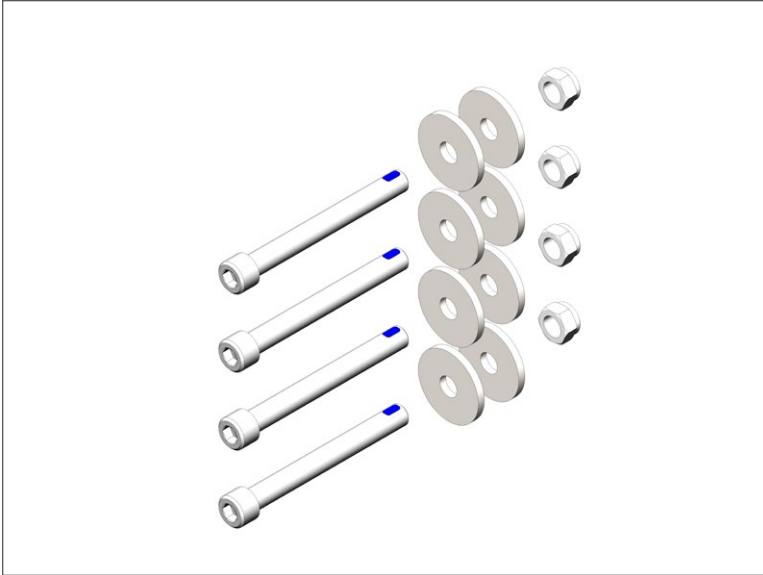

Product Code: XUHK1

DESCRIPTION

- Includes four 1/2" x 4-1/2" bolts, four nuts and eight washers.

COMPATIBILITY

X-Create	√
X-Rack	√
X-Siege	√
TR-1	√
TR-2	√

4 FT (2.4 M) SINGLE SIDE LOWER FRAME SUPPORT



Product Code: XSIEGE-4SSLFS

DESCRIPTION

- Ties together front and back uprights on 4 foot deep racks providing added stability.
- If using Vertical Accessory or Weight Storage Uprights, the 4SSLFS must be paired with X-Siege models.

COMPATIBILITY

X-Create	
X-Rack	√
X-Siege	√
TR-1	
TR-2	

2025 X-RACK & X-SIEGE COMPONENTS

4 FT (1.2 M) TRAY



Product Code: XCREATE-4TRAY

DESCRIPTION

- Over built to handle your heaviest accessories
- Can be mounted at an angle for ergonomic placement and retrieval of dumbbells
- Compatible with XCREATE-4MAT

COMPATIBILITY

X-Create	√
X-Rack	√
X-Siege	
TR-1	
TR-2	

4 FT (1.2 M) TRAY MAT



Product Code: XCREATE-4MAT

DESCRIPTION

- Over built to handle your heaviest accessories
- For use with XCREATE-4TRAY (qty 1) and XCREATE-8TRAY (qty 2)

COMPATIBILITY

X-Create	√
X-Rack	√
X-Siege	
TR-1	√
TR-2	√

2025 X-RACK & X-SIEGE COMPONENTS

6 FT (1.8 M) TRAY



Product Code: XCREATE-6TRAY

DESCRIPTION

- Over built to handle your heaviest accessories
- Can be mounted at an angle for ergonomic placement and retrieval of dumbbells
- Compatible with XCREATE-6MAT

COMPATIBILITY

X-Create	√
X-Rack	√
X-Siege	
TR-1	√
TR-2	√

6 FT (1.8 M) MAT



Product Code: XCREATE-6MAT

DESCRIPTION

- Over built to handle your heaviest accessories
- For use with XCREATE-6TRAY

COMPATIBILITY

X-Create	√
X-Rack	√
X-Siege	
TR-1	√
TR-2	√

2025 X-RACK & X-SIEGE COMPONENTS

8 FT (2.4 M) TRAY



Product Code: XCREATE-8TRAY

DESCRIPTION

- Over built to handle your heaviest accessories
- Can be mounted at an angle for ergonomic placement and retrieval of dumbbells
- Compatible with XCREATE-4MAT (2)

COMPATIBILITY

X-Create	√
X-Rack	√
X-Siege	
TR-1	√
TR-2	√

4 FT (1.2 M) BUMPER BOOKSHELF STORAGE

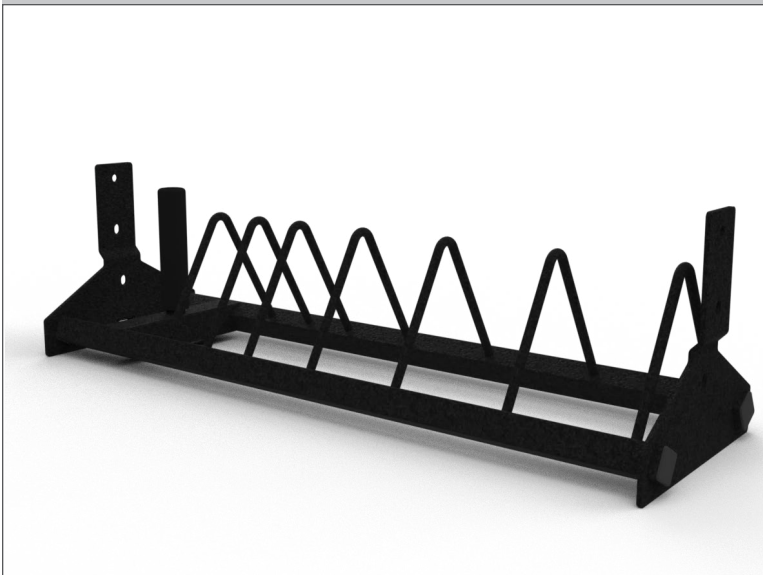

Product Code: XCREATE-4BBS

DESCRIPTION

- Maximizes bumper plate storage
- Holds smaller weights on vertical post and 10lb - 55lb bumper plates in vertical dividers

COMPATIBILITY

X-Create	√
X-Rack	√
X-Siege	
TR-1	
TR-2	

2025 X-RACK & X-SIEGE COMPONENTS

BALL & HANGING STORAGE



Product Code: XCREATE-4BHS

DESCRIPTION

- Rails designed to accommodate different diameter balls
- Adjustable curved pegs provide storage for exercise mats with holes spaced 15 in - 21.7 in (38 cm - 55 cm)
- Additional pegs to store various hanging accessories

COMPATIBILITY

X-Create	√
X-Rack	√
X-Siege	
TR-1	
TR-2	

4 FT (1.2 M) BALL STORAGE



Product Code: XCREATE-4BS

DESCRIPTION

- Minimalist rack for ball storage
- Fully welded and sized to accept any Torque Wall, Medicine or Slam Ball

COMPATIBILITY

X-Create	√
X-Rack	√
X-Siege	
TR-1	
TR-2	

2025 X-RACK & X-SIEGE COMPONENTS

SQUAT HANDLE ATTACHMENT



Product Code: XSHA

DESCRIPTION

- Features 6" handles with rubber grips
- Has a large, 2" diameter for comfort and stability when safety squatting

COMPATIBILITY

X-Create	√
X-Rack	√
X-Siege	√
TR-1	√
TR-2	√

6 FT (1.8 M) BUMPER BOOKSHELF STORAGE

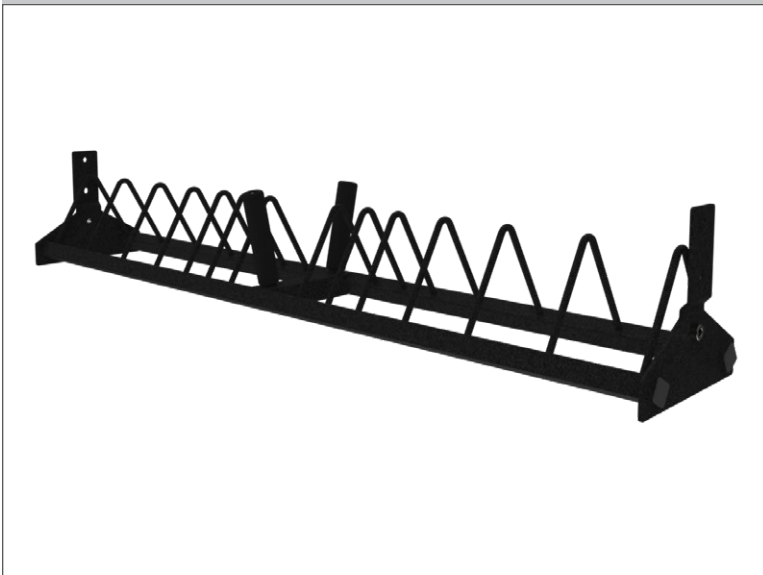

Product Code: XCREATE-6BBS

DESCRIPTION

- Maximizes bumper plate storage
- Holds smaller weights on vertical post and 10lb - 55lb bumper plates in vertical dividers

COMPATIBILITY

X-Create	√
X-Rack	√
X-Siege	
TR-1	√
TR-2	√

2025 X-RACK & X-SIEGE COMPONENTS

4 FT (1.2 M) SINGLE SIDE HOR. WEIGHT STORAGE



Product Code: XCREATE-4SSHWS

DESCRIPTION

- Standard as part of the X-CREATE Accessory and Weight Storage Module
- Compatible with any X-CREATE System
- Mounts between uprights and includes two nylon covered solid steel weight horns that are 11.25 inches (285 mm) long

COMPATIBILITY

X-Create	√
X-Rack	√
X-Siege	
TR-1	
TR-2	

4 FT (1.2 M) STALL BARS



Product Code: XCREATE-4SB

DESCRIPTION

- (12) 1.25 inch (32 mm) diameter rungs for targeted stretching, body weight and resistance training
- Textured High Wear Black powder coat paint provides a sure grip
- Compatible with XCREATE-DA and XCREATE-4BTWP

COMPATIBILITY

X-Create	√
X-Rack	√
X-Siege	
TR-1	
TR-2	

2025 X-RACK & X-SIEGE COMPONENTS

VERTICAL DUMBBELL STORAGE - 4 PAIR



Product Code: XCREATE-VDS4

DESCRIPTION

- Attaches to both standard and 2-sided X-CREATE 5 foot - 8 foot uprights to either an empty module, a ball and hanging storage module, or to the end of uprights on a system
- Holds four pairs of any size up to 55lb dumbbells
- Includes protective nylon edge protectors

COMPATIBILITY

X-Create	√
X-Rack	√
X-Siege	
TR-1	
TR-2	

VERTICAL DUMBBELL STORAGE - 5 PAIR



Product Code: XCREATE-VDS5

DESCRIPTION

- Attaches to both standard and 2-sided X-CREATE 5 foot - 8 foot uprights to either an empty module, a ball and hanging storage module, or to the end of uprights on a system
- Holds five pairs of any size up to 30lb dumbbells
- Includes protective nylon edge protectors

COMPATIBILITY

X-Create	√
X-Rack	√
X-Siege	
TR-1	
TR-2	

2025 X-RACK & X-SIEGE COMPONENTS

BALL & HANGING STORAGE EXTENSION



Product Code: XCREATE-BHSE

DESCRIPTION

- Add more storage to the ends of X-CREATE Systems
- Sized to hold a stability ball of any diameter
- Adjustable pegs allow storage of hanging mats, resistance bands, handles and more

COMPATIBILITY

X-Create	√
X-Rack	√
X-Siege	
TR-1	
TR-2	

VERTICAL BARBELL SIDE CONNECTOR (QTY 2)

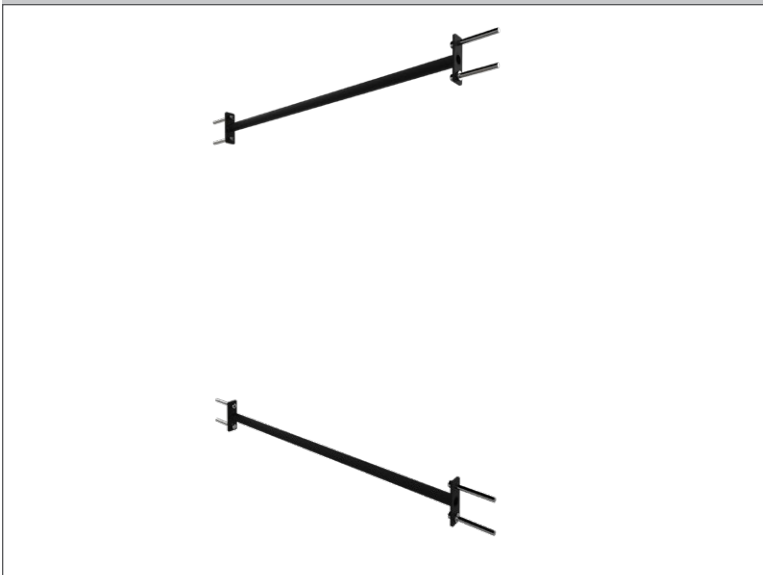

Product Code: XCREATE-VBSC

DESCRIPTION

- Mounts between the 5 foot uprights of barbell racks or between any X-CREATE uprights to add stability.
- Textured High Wear Black powder coat paint powder coat finish.

COMPATIBILITY

X-Create	√
X-Rack	
X-Siege	
TR-1	
TR-2	

2025 X-RACK & X-SIEGE COMPONENTS

PLYO-STEP ATTACHMENT



Product Code: XCREATE-AAPS

DESCRIPTION

- Used in conjunction with the XCREATE-AA Attachment Anchor
- The open design lends itself to visually guiding the attachment into place for easy attachments and adjustments
- Includes an integrated handle
- Features vinyl covered foam padding with landing zones

COMPATIBILITY

X-Create	√
X-Rack	√
X-Siege	
TR-1	
TR-2	

ATTACHMENT ANCHOR DIP



Product code: XCREATE-AAD

DESCRIPTION

- Used in conjunction with the XCREATE-AA Attachment Anchor
- The open design lends itself to visually guiding the attachment into place for easy attachments and adjustments
- Includes an integrated handle

COMPATIBILITY

X-Create	√
X-Rack	√
X-Siege	
TR-1	
TR-2	

2025 X-RACK & X-SIEGE COMPONENTS

VERTICAL BARBELL SIDES - 5 BARBELLS (2 PCS - PAIR)



Product Code: XCREATE-VBS5

DESCRIPTION

- Mounts to X-CREATE 5 foot, 7 foot and 8 foot uprights to hold 5 straight or EZ curl barbells.
- Includes molded nylon guards to protect barbells and numbered labels.

COMPATIBILITY

X-Create	√
X-Rack	√
X-Siege	
TR-1	
TR-2	

VERTICAL BARBELL SIDES - 10 BARBELLS (2 PCS - PAIR)

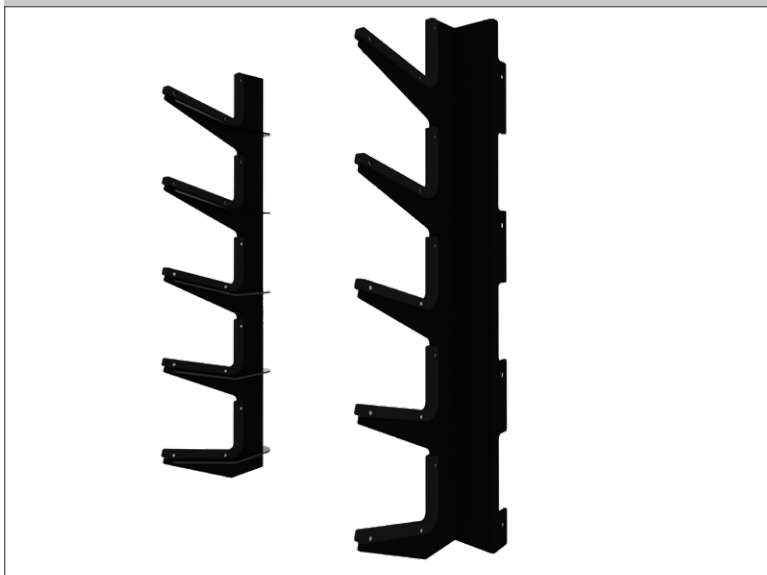

Product Code: XCREATE-VBS10

DESCRIPTION

- Mounts to X-CREATE 5 foot, 7 foot and 8 foot uprights to hold 10 straight or EZ curl barbells.
- Each pair of hooks hold two barbells.
- Includes molded nylon guards to protect barbells and numbered labels.

COMPATIBILITY

X-Create	√
X-Rack	√
X-Siege	
TR-1	
TR-2	

2025 X-RACK & X-SIEGE COMPONENTS

4 FT (1.2 M) MONITOR MOUNT



Product Code: XCREATE-4MM

DESCRIPTION

- Attaches to any X-CREATE 4 foot (1.2 m) module space
- Compatible with flat screen monitors up to 43 inches
- Standard VESA mount

COMPATIBILITY

X-Create	√
X-Rack	√
X-Siege	
TR-1	
TR-2	

4 FT (1.2 M) CABLE STATION CROSS

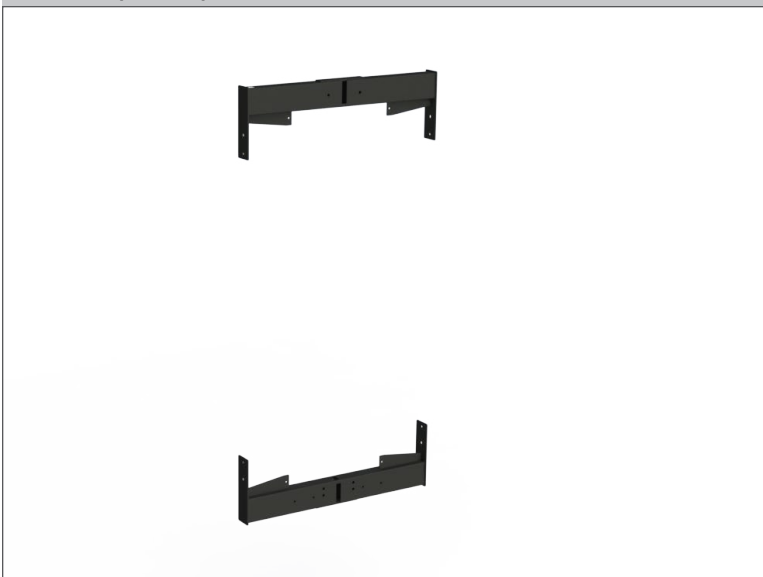

Product Code: XCREATE-4CSX

DESCRIPTION

- Includes top and bottom cross members for attaching the X-CREATE Cable Column, Seated Row, and Lat Pulldown frames to a module space.
- Included with modules.
- If cable stations are orientated back to back in a module space, they share one of these components.

COMPATIBILITY

X-Create	√
X-Rack	√
X-Siege	
TR-1	
TR-2	

2025 X-RACK & X-SIEGE COMPONENTS

CABLE STATION TOP CAP



Product Code: XCREATE-CSTC

DESCRIPTION

- Injection molded top cap for the X-CREATE Cable Column, Seated Row, and Lat Pulldown Modules and Wall mounts.
- Included with all X-CREATE Cable Stations.

COMPATIBILITY

X-Create	√
X-Rack	√
X-Siege	
TR-1	
TR-2	

CABLE STATION SHROUD - FRONT (2 PIECES - PAIR)



Product Code: XCREATE-CSSF

DESCRIPTION

- Front shroud pair for the X-CREATE Cable Column, Seated Row, and Lat Pulldown Modules and Wall mounts.
- Included with modules.
- Placards are included with the individual station frames and are attached after assembly.

COMPATIBILITY

X-Create	√
X-Rack	√
X-Siege	
TR-1	
TR-2	

2025 X-RACK & X-SIEGE COMPONENTS

CABLE COMPONENT

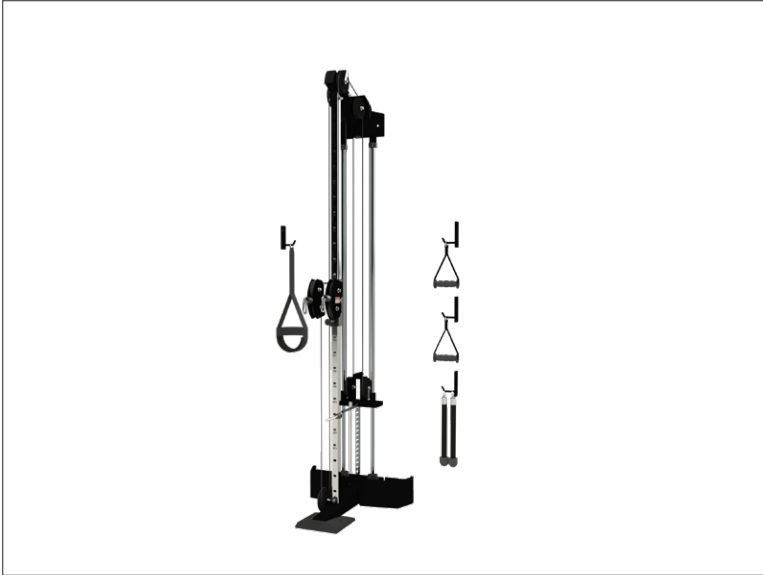

Product Code: XCREATE-CC

DESCRIPTION

- Frame assembly for the X-CREATE Cable Column Module and Wall Mount.
- Includes headplate, cable and accessories.

COMPATIBILITY

X-Create	√
X-Rack	√
X-Siege	
TR-1	
TR-2	

LAT PULL DOWN



Product Code: XCREATE-LPD

DESCRIPTION

- Frame assembly for the X-CREATE Lat Pulldown Module and Wall Mount.
- Includes black pads, headplate, cable and aluminum lat bar.
- Adjustable knee hold-down.

COMPATIBILITY

X-Create	√
X-Rack	√
X-Siege	
TR-1	
TR-2	

2025 X-RACK & X-SIEGE COMPONENTS

SEATED ROW



Product Code: XCREATE-SR

DESCRIPTION

- Frame assembly for the X-CREATE Seated Row Module and Wall Mount.
- Includes black pad, headplate, cable and aluminum low row handle.
- Urethane molded foot placements and frame protector.

COMPATIBILITY

X-Create	√
X-Rack	√
X-Siege	
TR-1	
TR-2	

CABLE STATION SHROUD - REAR

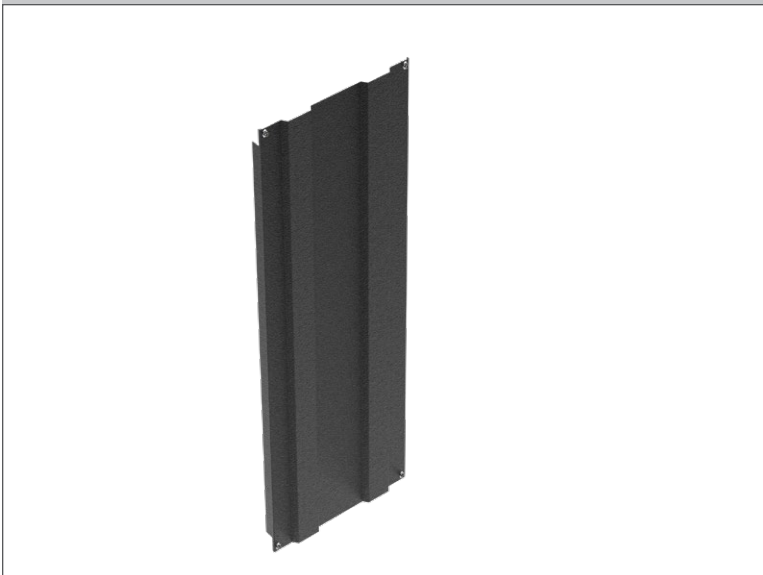

Product Code: XCREATE-CSSR

DESCRIPTION

- Rear shroud option for X-CREATE Cable Column, Lat Pulldown and Seated Row Modules.
- Recommended for Two-sided X-CREATE with cable stations only on one side or for X-CREATE Wall Systems that are not placed along a wall.

COMPATIBILITY

X-Create	√
X-Rack	√
X-Siege	
TR-1	
TR-2	

2025 X-RACK & X-SIEGE COMPONENTS

8 FT (2.4 M) UPRIGHT VERTICAL WEIGHT STORAGE, SINGLE

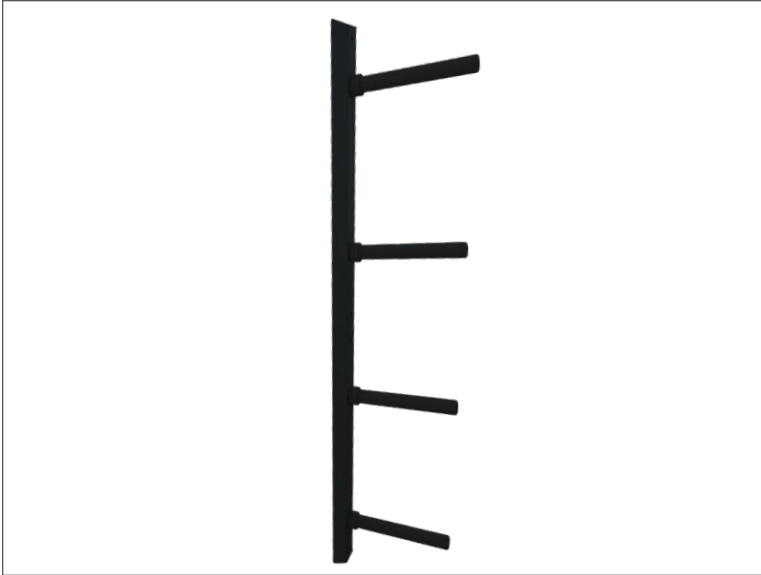

Product Code: XCREATE-8UVWSS

DESCRIPTION

- Mounts to the side of X-CREATE 8 foot standard and 2-sided uprights to provide weight storage.
- Four solid steel weight pegs with nylon covers and rubber bumpers protect weight plates.
- Each 11.25 in (286 mm) long peg holds up to 4 Torque 45 lb bumper plates or 6 Torque 45 lb grip plates.

COMPATIBILITY

X-Create	√
X-Rack	√
X-Siege	
TR-1	
TR-2	

8 FT (2.4 M) UPRIGHT VERTICAL WEIGHT STORAGE (QTY 2)

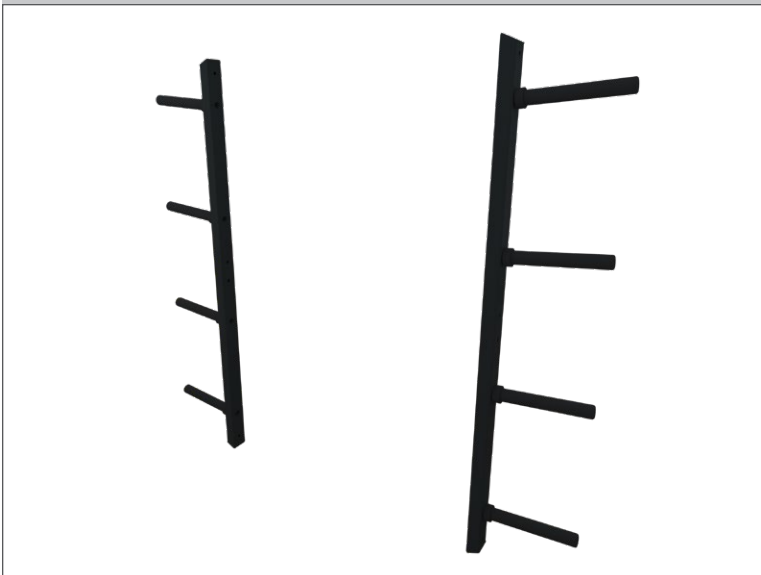

Product Code: XCREATE-8UVWS

DESCRIPTION

- Mounts to the side of X-CREATE 7 and 8 foot uprights to provide weight storage
- Eight solid steel weight pegs with nylon covers and rubber bumpers protect weight plates
- Each 11.25 inch (286 mm) long peg holds up to 4 Torque 45 lb bumper plates or 6 Torque 45 lb grip plates. Also available as a single (XCREATE-8UVWSS)

COMPATIBILITY

X-Create	√
X-Rack	√
X-Siege	
TR-1	
TR-2	

2025 X-RACK & X-SIEGE COMPONENTS

8 FT (2.4 M) ATTACHMENT UPRIGHT (STORM GREY)



Product Code: XRACK-8AU

DESCRIPTION

- Substitute for any standard 8 foot upright in order to attach trays, weight storage or training attachments.
- Cannot be used with Bar Supports or Bar Catches.
- Available only in storm grey powder coat finish.

COMPATIBILITY

X-Create	
X-Rack	√
X-Siege	√
TR-1	
TR-2	

9 FT (2.7 M) ATTACHMENT UPRIGHT (STORM GREY)



Product Code: XRACK-9AU

DESCRIPTION

- Substitute for any standard 9 foot upright in order to attach trays, weight storage or training attachments.
- Cannot be used with Bar Supports or Bar Catches.
- Available only in storm grey powder coat finish.

COMPATIBILITY

X-Create	
X-Rack	√
X-Siege	√
TR-1	
TR-2	

2025 X-RACK & X-SIEGE COMPONENTS

WEIGHT STACK PLATES - 10 LB x 5

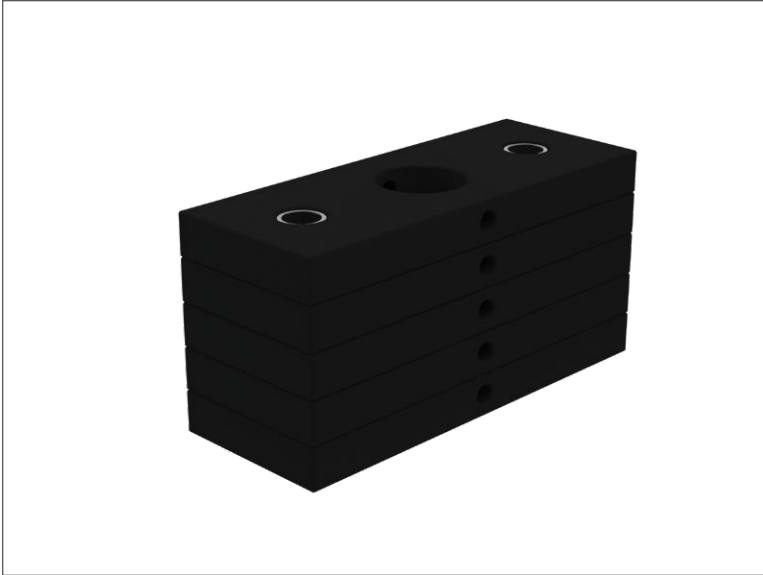

Product Code: WSP10-5

DESCRIPTION

- Box of five 10 lb powdercoated steel weight plates with bushings
- Used with Cable Column Stations, Seated Row, and Lat Pulldown

COMPATIBILITY

X-Create	√
X-Rack	√
X-Siege	√
TR-1	
TR-2	

WEIGHT STACK PLATES - 15 LB x 5



Product Code: WSP15-5

DESCRIPTION

- Box of five 15 lb powdercoated steel weight plates with bushings
- Used with Cable Column Stations, Seated Row, and Lat Pulldown

COMPATIBILITY

X-Create	√
X-Rack	√
X-Siege	√
TR-1	
TR-2	

2025 X-RACK & X-SIEGE COMPONENTS

WEIGHT STACK PLATES - 20 LB x 5



Product Code: WSP20-5

DESCRIPTION

- Box of five 20 lb powdercoated steel weight plates with bushings
- Used with Cable Column Stations, Seated Row, and Lat Pulldown

COMPATIBILITY

X-Create	√
X-Rack	√
X-Siege	√
TR-1	
TR-2	

UNIVERSAL BALL STORAGE HANGING PEGS (QTY 6)



Product Code: XCREATE-UBSHP6

DESCRIPTION

- Hanging storage pegs mountable to the XCREATE-4CSB to create a hanging storage module
- Supports hanging mats, straps and bands. Horizontally adjustable for mats with varying hole widths
- 16mm diameter with grooves to retain mats. Includes nuts to attach

COMPATIBILITY

X-Create	√
X-Rack	√
X-Siege	√
TR-1	
TR-2	

2025 X-RACK & X-SIEGE COMPONENTS

BAR CATCH STORAGE ATTACHMENT (QTY 2)

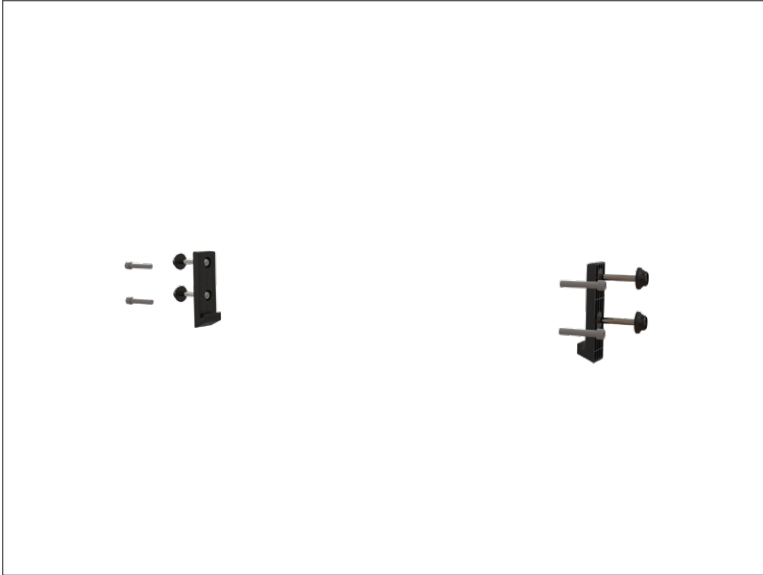

Product Code: BCSA

DESCRIPTION

- Stows Bar Catches on uprights when not in use
- Standard on TR-2 Series racks

COMPATIBILITY

X-Create	√
X-Rack	√
X-Siege	√
TR-1	√
TR-2	√

CHANGE PLATE WEIGHT HORN (QTY 2)

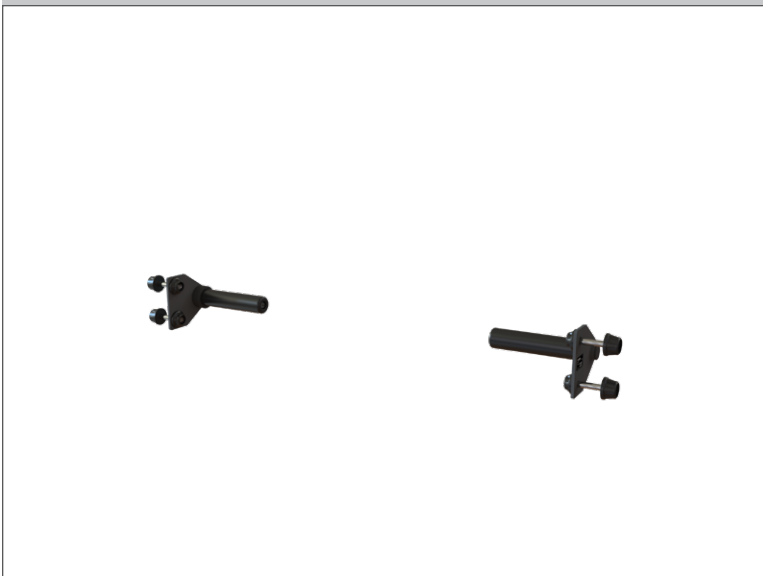

Product Code: CPWH

DESCRIPTION

- Mounts to X-CREATE, X-RACK and X-SIEGE uprights
- Four steel weight pegs with nylon covers and rubber bumpers protect weight plates

COMPATIBILITY

X-Create	√
X-Rack	√
X-Siege	√
TR-1	√
TR-2	

2025 X-RACK & X-SIEGE COMPONENTS

4 FT (1.2 M) BALL TARGET WALL PAD



Product Code: XCREATE-4BTWP

DESCRIPTION

- Adjustable and removable
- Heavy duty vinyl covered foam pad equipped with sound dampening hooks
- Attaches to XCREATE-4SB (up to qty 3 per side)

COMPATIBILITY

X-Create	√
X-Rack	√
X-Siege	
TR-1	
TR-2	

6 FT (1.8 M) BALL & HANGING STORAGE



Product Code: XCREATE-6BHS

DESCRIPTION

- Rails designed to accommodate different diameter balls
- Adjustable curved pegs provide storage for exercise mats with holes spaced 15 in - 21.7 in (38 cm - 55 cm)
- Additional pegs to store various hanging accessories

COMPATIBILITY

X-Create	√
X-Rack	√
X-Siege	
TR-1	√
TR-2	√

2025 X-RACK & X-SIEGE COMPONENTS

8 FT (2.4 M) SADDLE DUMBBELL RACK TIER



Product Code: XCREATE-8SDRT

DESCRIPTION

- Compatible with all X-CREATE uprights to add storage for Pro-Style dumbbells
- Holds up to 5 pairs of dumbbells per tray

COMPATIBILITY

X-Create	√
X-Rack	√
X-Siege	
TR-1	√
TR-2	√

ATTACHMENT ANCHOR



Product Code: XCREATE-AA

DESCRIPTION

- Required with XCREATE-AAD and XCREATE-AAPS
- Mounts to X-CREATE 5 foot - 8 foot uprights for use with the Dip and Plyo Step attachments
- Machined chrome plated pegs keep attachments secure and easy to attach and remove

COMPATIBILITY

X-Create	√
X-Rack	√
X-Siege	
TR-1	
TR-2	

2025 X-RACK & X-SIEGE COMPONENTS

BRIDGE BALL TARGET



Product Code: XCREATE-BBT

DESCRIPTION

- Attaches to X-CREATE Bridge or 6 foot Rectangular Cross
- Provides both a 9 foot (2.7 m) and 10 foot (3.0 m) target height
- Welded, rigid construction with durable, textured powder coat

COMPATIBILITY

X-Create	√
X-Rack	√
X-Siege	
TR-1	
TR-2	

FOAM ROLLER STORAGE



Product Code: XCREATE-FRS6-8

DESCRIPTION

- Mounts to the side of X-CREATE uprights
- Holds qty 8 foam rollers up to 6 inches in diameter

COMPATIBILITY

X-Create	√
X-Rack	√
X-Siege	
TR-1	
TR-2	

2025 X-RACK & X-SIEGE COMPONENTS

BACK EXTENSION (BOX 1/2)



Product Code: XCREATE-BE-101

DESCRIPTION

- Contains main frame, footplates, and linear guide rod adjustment system
- Urethane molded foot plate covers provide a firm grip during use
- Requires XCREATE-BE-201 to complete unit

COMPATIBILITY

X-Create	√
X-Rack	√
X-Siege	
TR-1	
TR-2	

BACK EXTENSION (BOX 2/2)



Product Code: XCREATE-BE-201

DESCRIPTION

- Contains seat adjustment, pads and hardware
- Includes a multi-grip handle with swivel
- High density pads for comfort and durability
- Requires XCREATE-BE-101 to complete unit

COMPATIBILITY

X-Create	√
X-Rack	√
X-Siege	
TR-1	
TR-2	

2025 X-RACK & X-SIEGE COMPONENTS

HIP THRUST (BOX 1/2)



Product Code: XCREATE-HT-101

DESCRIPTION

- Includes the seat, back pads, lap belt, hardware, assembly instructions and placards
- XCREATE-HT-201 required to make a complete unit

COMPATIBILITY

X-Create	√
X-Rack	√
X-Siege	
TR-1	
TR-2	

HIP THRUST (BOX 2/2)



Product Code: XCREATE-HT-201

DESCRIPTION

- Includes head plate, top boom, cable assemblies, support tubes and base
- XCREATE-HT-101 required to make a complete unit

COMPATIBILITY

X-Create	√
X-Rack	√
X-Siege	
TR-1	
TR-2	

2025 X-RACK & X-SIEGE COMPONENTS

STANDING HIP ABDUCTOR (BOX 1/2)

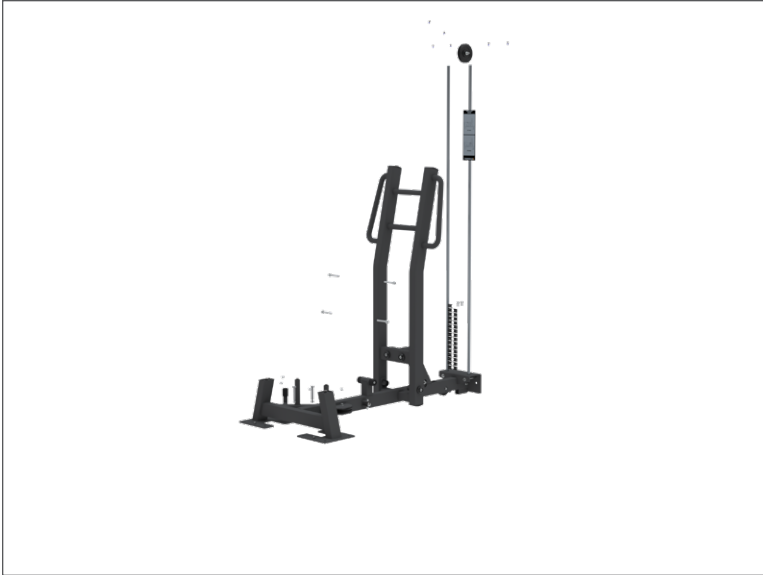

Product Code: XCREATE-SHA-101

DESCRIPTION

- Includes base and handle mount weldments, as well as instructions, artwork and hardware required for assembly
- XCREATE-SHA-201 required to complete unit

COMPATIBILITY

X-Create	√
X-Rack	√
X-Siege	
TR-1	
TR-2	

STANDING HIP ABDUCTOR (BOX 2/2)



Product Code: XCREATE-SHA-201

DESCRIPTION

- Includes movement arms, pads, foot plate, top boom and cable assemblies
- XCREATE-SHA-101 required to complete unit

COMPATIBILITY

X-Create	√
X-Rack	√
X-Siege	
TR-1	
TR-2	

2025 X-RACK & X-SIEGE COMPONENTS

HOOK, MAGNETIC SUSPENSION CLIP (QTY 2)



Product Code: XCREATE-HMSC

DESCRIPTION

- Attaches to any 3 inch (75 mm) wide tube with magnets and is used to capture and retain suspension straps when not in use

COMPATIBILITY

X-Create	√
X-Rack	√
X-Siege	√
TR-1	√
TR-2	√

4 FT (1.2 M) HIP THRUST CABLE STATION CROSS

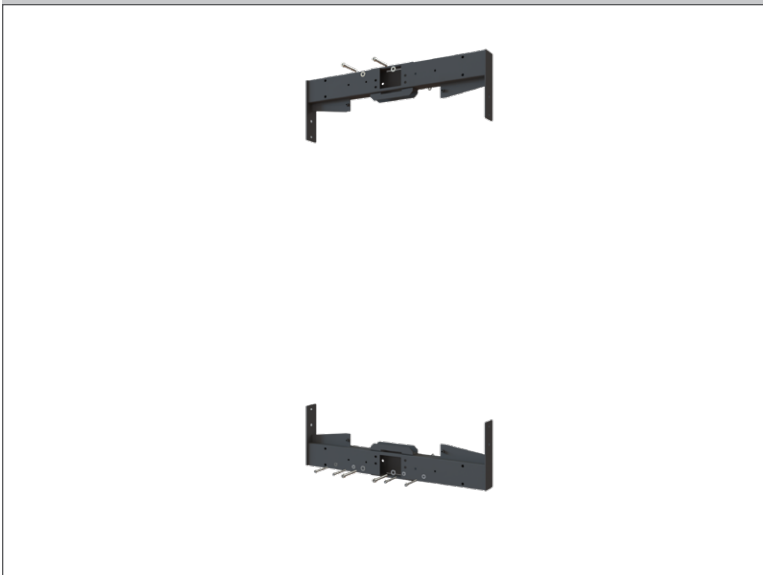

Product Code: XCREATE-HTCSX

DESCRIPTION

- Includes top and bottom cross members for attaching the X-CREATE Hip Thrust frame to a module space
- Included with module
- If cable stations are orientated back to back in a module space, they share one of these components

COMPATIBILITY

X-Create	√
X-Rack	√
X-Siege	
TR-1	
TR-2	

2025 X-RACK & X-SIEGE COMPONENTS

STORAGE ATTACHMENT, BOSU (2 PIECES)



Product Code: XCREATE-SA-BOSU-2

DESCRIPTION

- Every box includes 2 BOSU Storage Attachment brackets that can be assembled on the same or different X-CREATE uprights
- Holds one BOSU per piece

COMPATIBILITY

X-Create	√
X-Rack	√
X-Siege	
TR-1	
TR-2	

BELT SQUAT, X-RACK



Product Code: XRACK-BSQUAT

DESCRIPTION

- Belt squat attachment that bolts to the base of Torque Rigs and Racks
- Folding kickstand has a magnetic latch to ensure it is out of the way during exercise
- Starting weight of 30 lbs (13.6 kg)
- Belt, chain, hook, and carabiner included

COMPATIBILITY

X-Create	√
X-Rack	√
X-Siege	√
TR-1	
TR-2	